

**WELLINGTON NEIGHBORHOOD ASSOCIATION  
APPLICATION FOR DESIGN REVIEW**

DATE SUBMITTED: 9/14/2012

NAME: Leslie Day

ADDRESS: 14 Leapfrog Green

TELEPHONE: 970 389-7475

EMAIL ADDRESS: \_\_\_\_\_

The Design Review Committees will receive the packets including all the above information and may call or walk your property to get a better sense of the project. Please be sure to provide phone # or an email address where you can easily be reached. Getting questions answered and clarified before the formal meetings will streamline the approval process and you will be able to start the real work with the neighborhoods approval.

Application shall also have attached a site plan of your lot, detailed plan for the improvement and elevations if applicable to the project. All plans should be submitted on paper no larger than 8 1/2x14.

Please include the following information below:

1. Description of the improvement: Rock flower beds, sod, flagstone patio, additional trees

\_\_\_\_\_  
\_\_\_\_\_

2. Description of materials to be used: sod, perennials, rock, flagstone

\_\_\_\_\_

3. Colors: Natural colors

4. Construction schedule & Contractor: \_\_\_\_\_ Following approval. \_\_\_\_\_

5. Anticipated start and Completion date: Following approval weather pending

6. Location on property and dimensions: (Shown on Site plan)

LESLIE DRY 970.389.7475  
14 LEAF FROG GREEN

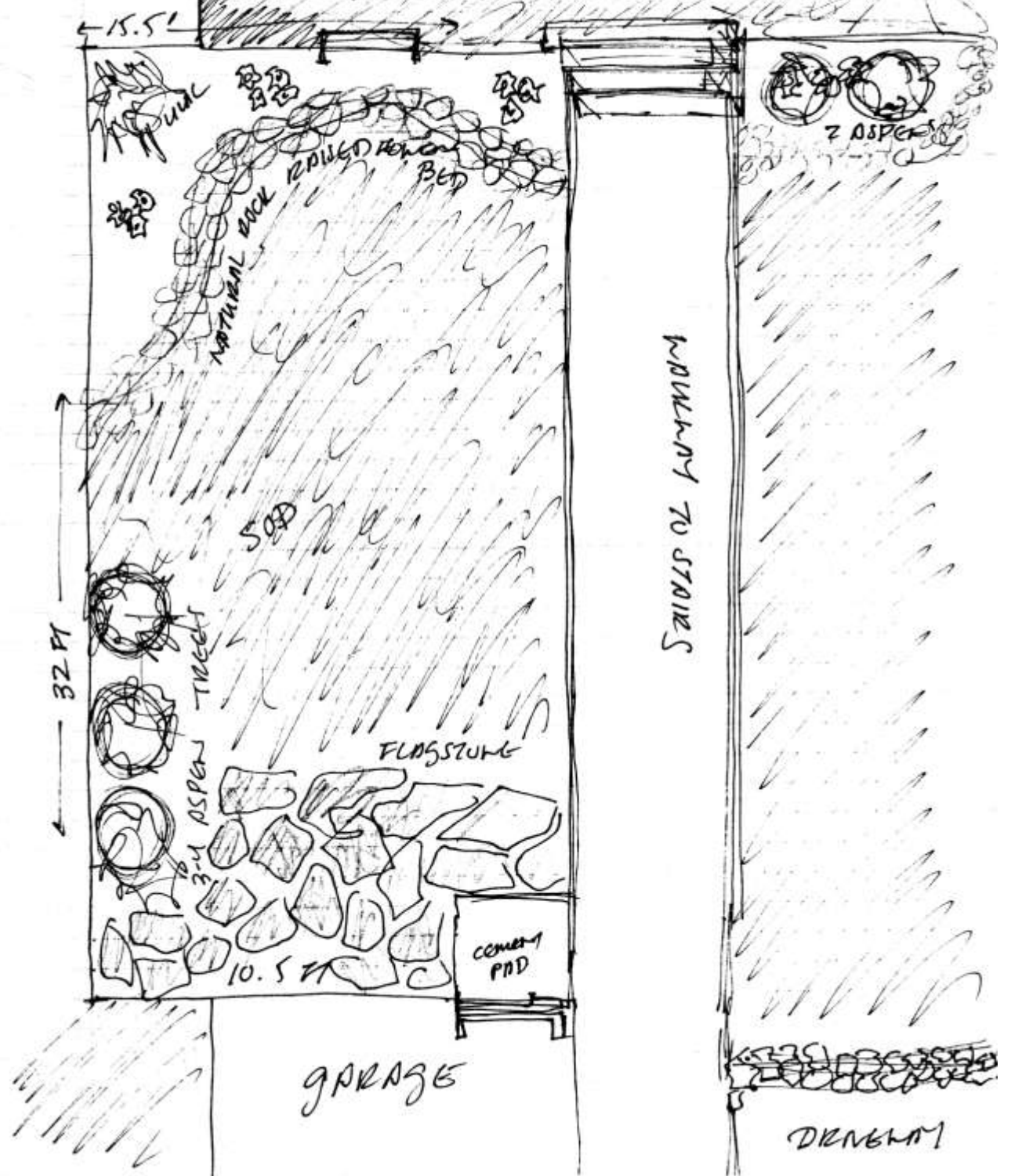

32 FT

15.5'

10.5 FT

GARAGE

WALKWAY TO STAIRS

DRAINAGE

CEMENT PAD

FLAGSTONE

SOD

3-4 ASPEN TREES

NATURAL ROCK  
BED

2 ASPEN